

Pneutork Manual Over-Ride Worm Gear boxes are used with pneumatic, hydraulic and back-drivable electric actuators. These products are sandwich mounted as part of an automated valve package to provide manual operation to the valve and manually over-riding pneumatic actuators in case of loss in plants air supply, power gas, hydraulic fluid power or electricity occurs. These gearboxes are engineered and designed for higher efficiencies and lower efforts on hand wheel which are used with valves and dampers for quarter turn rotary applications that comes with thirteen different frames and spur combinations to provide output torque range from 60 to 5,000 Nm. These gearboxes are designed with standard ISO 5211 mounting dimensions for mounting to valve & actuator

No.	Name of Part	Material Specification
1	Body	Cast Iron (Gr. FG 260)
2	Cover	Cast Iron (Gr. FG 260)
3	Body Gasket	Rubber Cork
4	Worm Wheel	SG Iron (Gr. 500/7)
5	O-Ring (For Worm Wheel)	NBR
6	Worm	EN8
7	Shaft	EN8
8	Dowel Pin (for Worm& Shaft)	SS304
9	Eccentric Bush	CI
10	Hex Bolt (for Body & Cover)	MS (Zinc Plated)
11	Hex Bolt Washer (for Body & Cover)	MS (Zinc Plated)
12	Adjustable Hex Bolt	MS (Zinc Plated)
13	Adjustable Hex Nut	MS (Zinc Plated)
14	Clutch Lever	MS
15	Grub Screw (for Clutch & Bush)	Spring Steel
16	Clutch (knob assembly)	MS (Zinc Plated)
17	Hand Wheel	MS (Powder Coated)
18	Bot for Hand Wheel	MS (Zinc Plated)
19	Washer for Hand Wheel	MS (Zinc Plated)

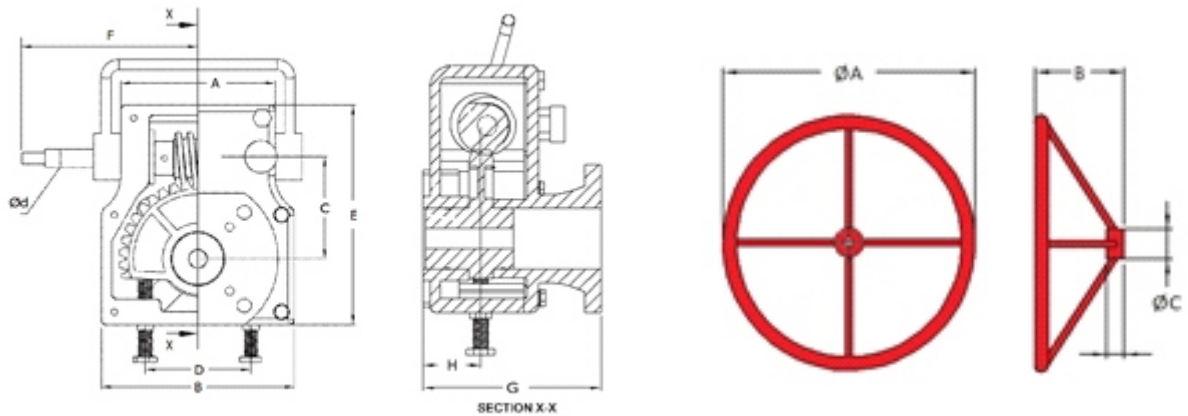
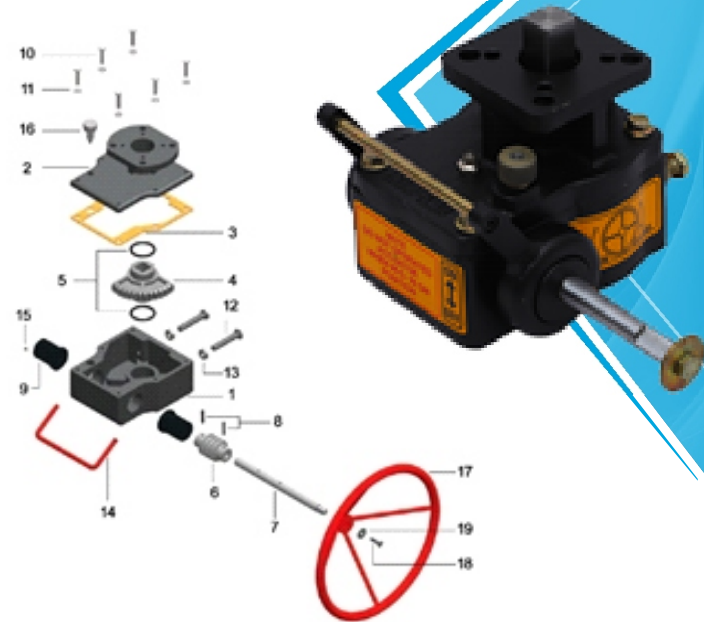

MODEL	Rated Output Torque (Nm)	Mechanical Advantage ±10%	Gear Ratio	Turns To Close	ISO 5211 Mounting	Hand Wheel Ø (mm)	Dimensions							Wheel Dimension					
							A	B	C	D	E	F	G	Ød	Hand Wheel Dia Ø A	Height Ø G	Bush OD Ø C	Bush Length L	No. Of Spokes
MOR-100	100	8	36:1	9	F05, F07	180	83	100	52.50	50	121	128.5	101	12	180	70	30	18	3
MOR-250	250	8	36:1	9	F05, F07	180	83	100	52.50	50	121	128.5	101	12	250	85	30	18	3
MOR-450	450	8.4	38:1	9.5	F07, F10	250	120	150	78.90	58	170	137	123.5	14	300	90	30	18	4
MOR-750	750	10	45:1	11.5	F07, F10, F12	350	118	169	89.50	62	192	194.6	126	16	350	110	30	18	4
MOR-1000	1000	13.2	60:1	15	F10, F12, F14	350	140	216	111.70	150	214	208	126	16	400	130	30	25	4
MOR-1500	1500	16.5	76:1	19	F10, F12, F14	350	180	270	136.50	200	246	187	146	16	450	145	40	25	4
MOR-3500	3500	16	72:1	18	F12, F14F, F16	450	232	340	173	220	313	230	186	25	500	145	40	30	4
MOR-5000	5000	18	90:1	20	F16, F20	600	306	435	209	250	385	380	180	25	600	150	40	30	5

► Standard Orientation View of Worm Wheel from Top at closed position

